

TO  
Pg 1E  
Pole  
099650

Pole with  
blue paint  
#7

102' 50"

23' 6"

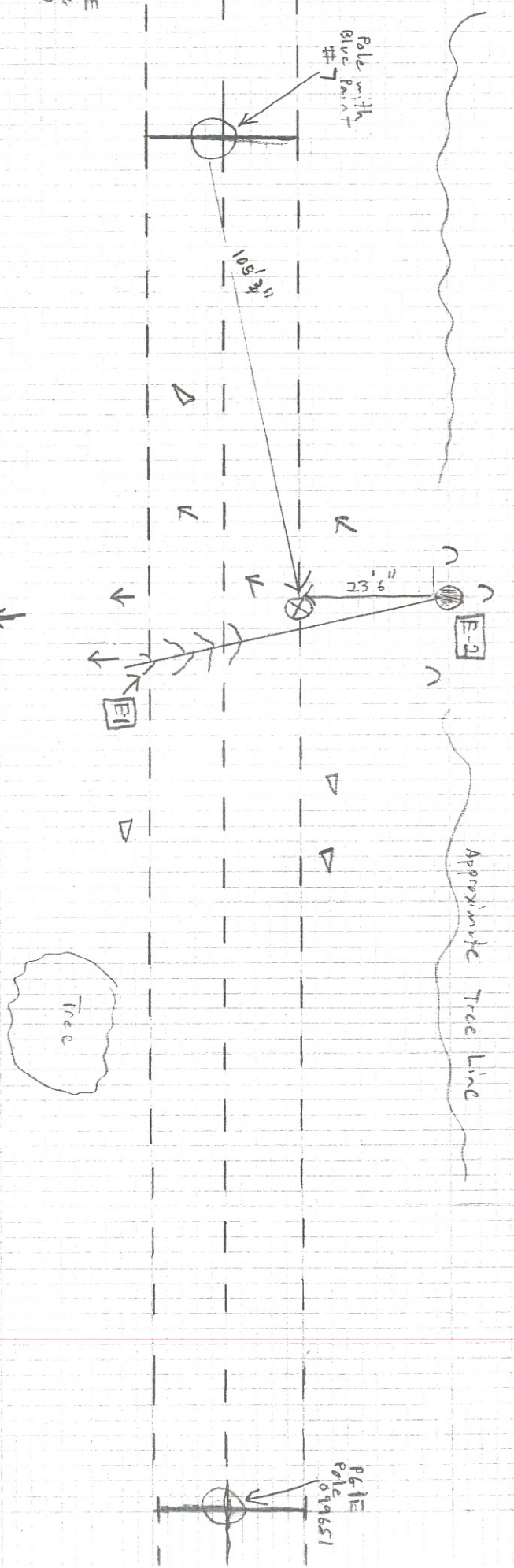

Legend

Bull's  
Incident Sketch  
(Not To Scale)

Date: 9/9/15

- Conductors
- Evidence
- ⊗ Origin Area
- U Backing Indicator
- △ Lateral Indicator
- ↓ Advancing Indicator

N

E-1 Approximate Tree Length - 44' 2"

By: G. Muschatto